

| (1) | (2) | (3) | (4) | (5) | (6) | (7) | (8) |
|--------|------|-------|------------------|-------------|-------|---|------|
| ILLUS. | | | | | | | QTY |
| (a) | (b) | SMR | NATIONAL | PART | | DESCRIPTION | U/M |
| FIG. | ITEM | STOCK | STOCK | NUMBER | FSCM | | INC |
| NO. | NO. | CODE | NUMBER | | | USABLE ON CODE | IN |
| | | | | | | | UNIT |
| | | | | | | 0312 - ACCELERATOR, THROTTLE OR CHOKE CONTROLS | |
| 22 | 1 | PAOZZ | 5305-00-990-6444 | MS35207-261 | 96906 | SCREW AB,AC | EA 1 |
| 22 | 2 | PAOZZ | 5315-00-839-2325 | MS24665-132 | 96906 | PIN,COTTER AB,AC | EA 4 |
| 22 | 3 | PAOZZ | 2990-00-968-0033 | 10896700 | 19207 | SWIVEL AB,AC | EA 1 |
| 22 | 4 | PAOZZ | 5310-00-934-9757 | MS35649-282 | 96906 | NUT, PLAIN, HEXAGON AB,AC | EA 1 |
| 22 | 5 | PAOZZ | 5310-00-596-7693 | MS35335-31 | 96906 | WASHER, LOCK AB,AC | EA 2 |
| 22 | 6 | PAOZZ | 5305-00-984-6193 | MS35206-245 | 96906 | SCREW, MACHINE AB,AC | EA 1 |
| 22 | 7 | PAOZZ | 9905-00-178-4807 | 7060066 | 19207 | CLIP, MARKER, BLANK AB,AC | EA 1 |
| 22 | 8 | PAOZZ | 5325-00-263-6632 | MS35489-6 | 96906 | GROMMET, RUBBER AB,AC | EA 1 |
| 22 | 9 | PAOZZ | 5310-00-959-1488 | MS51922-21 | 96906 | NUT, PLAIN, HEXAGON: THROTTLE CONTROL, CHOKE CONTROL AB,AC | EA 2 |
| 22 | 10 | PAOZZ | 5310-00-637-9541 | MS35338-46 | 96906 | WASHER, LOCK: CONTROL AB,AC | EA 2 |
| 22 | 11 | PAOZZ | 2990-00-077-1940 | 10872080-2 | 19207 | CONTROL: PUSH PULL,ENGINE STOP AB,AC | EA 1 |
| 22 | 12 | PAOZZ | 3040-00-115-4364 | 10896278 | 19207 | CLIP, THROTTLE, RETURN AB,AC | EA 1 |
| 22 | 13 | PAOZZ | 5360-00-753-9129 | 7539129 | 19207 | SPRING, HELICAL, EXTENSION: RETURN, THROTTLE AB,AC | EA 1 |
| 22 | 14 | PAOZZ | 5315-00-845-4232 | MS35810-32 | 96906 | PIN, STRAIGHT, HEADED: ACCELERATOR ROD AB,AC | EA 1 |
| 22 | 15 | PAOZZ | 5305-00-889-3002 | MS35206-242 | 96906 | SCREW, MACHINE AB,AC | EA 1 |
| 22 | 16 | PAOZZ | 2910-00-753-9184 | 7539184 | 19207 | CONNECTOR, THROTTLE AB,AC | EA 1 |
| 22 | 17 | PAOZZ | 5306-00-737-3263 | 7373263 | 19207 | BOLT, INTERNALLY RELIEVED BODY AB,AC | EA 1 |
| 22 | 18 | PAOZZ | 5310-00-959-1488 | MS51922-21 | 96906 | NUT, SELF-LOCKING AB,AC | EA 1 |
| 22 | 19 | PAOZZ | 2590-00-679-3179 | 7373341 | 19207 | CONTROL ASSEMBLY: W/"T" HANDLE ASSEMBLY AB,AC | EA 1 |
| 22 | 20 | PAOZZ | 5310-00-984-3807 | MS51922-13 | 96906 | NUT, SELF-LOCKING AB,AC | EA 2 |
| 22 | 21 | PAOZZ | 5310-00-080-6004 | MS27183-14 | 96906 | WASHER, FLAT AB,AC | EA 1 |
| 22 | 22 | PAOZZ | 5310-00-061-1258 | MS45904-76 | 96906 | WASHER, LOCK AB,AC | EA 1 |
| 22 | 23 | PAOZZ | 2590-00-739-7791 | 7397791 | 19207 | LEAD, ELECTRICAL AB,AC | EA 1 |
| 22 | 24 | PAOOO | 3040-00-437-7189 | 11609179 | 19207 | LINKAGE ASSEMBLY: ACCELERATOR AB,AC | EA 1 |
| 22 | 25 | PAOZZ | 5315-00-059-0157 | MS24665-210 | 96906 | PIN, COTTER AB,AC | EA 2 |
| 22 | 26 | PAOZZ | 5310-00-176-6132 | 10896537 | 19207 | WASHER, FLAT AB,AC | EA 1 |
| 22 | 27 | PAOZZ | 5360-00-144-6786 | 10896488 | 19207 | SPRING, HELICAL AB,AC | EA 1 |
| 22 | 28 | PAOZZ | 2590-00-485-9481 | 10896533 | 16207 | SWIVEL ASSEMBLY AB,AC | EA 1 |

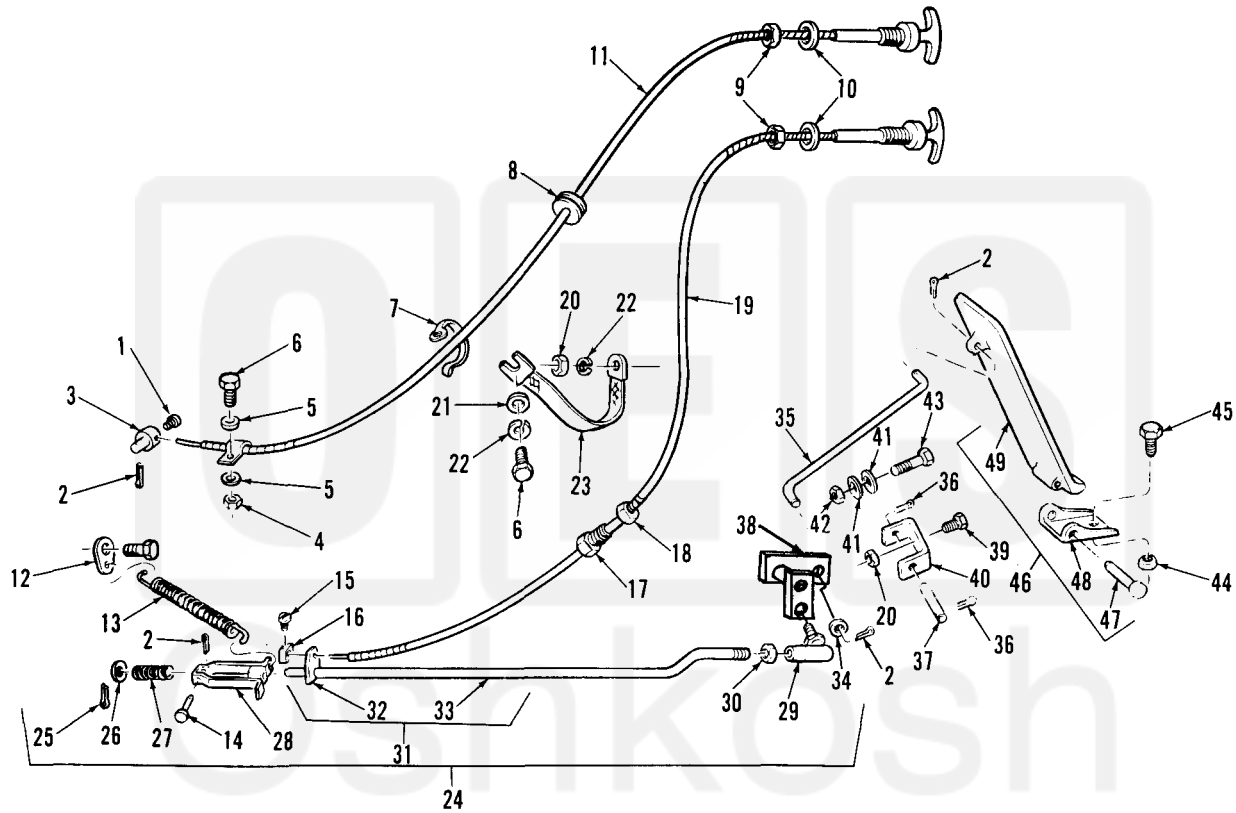



TA 096369

Figure 22. Throttle linkage and controls (multifuel).